

# **BOARD OF SUPERVISORS**

# **MADISON COUNTY, MISSISSIPPI**

Department of Engineering  
Tim Bryan, P.E., PTOE, County Engineer

3137 South Liberty Street, Canton, MS 39046  
Office (601) 855-5582 FAX (601) 859-5857

## **MEMORANDUM**

May 8, 2025

To: Casey Brannon, Supervisor, District I  
Trey Baxter, Supervisor, District II  
Gerald Steen, Supervisor, District III  
Karl Banks, Supervisor, District IV  
Paul Griffin, Supervisor, District V

From: Tim Bryan, P.E., PTOE  
County Engineer

Re: Comcast Utility Permit  
County Road Name, Baleigh Drive

The Engineering Department recommends approval for Comcast to bore 9586' placing cable and conduit for the county roads listed below as shown on the attached plans:

- Yandell Road
- Hunter's Way
- Baleigh Way
- Baleigh Drive
- Mandy Way
- Portner Way

---

CASEY BRANNON  
District One

TREY BAXTER  
District Two

GERALD STEEN  
District Three

KARL M. BANKS  
District Four

PAUL GRIFFIN  
District Five



**PERMIT APPLICATION FOR THE CONSTRUCTION OR ADJUSTMENT  
OF A UTILITY WITHIN COUNTY ROAD RIGHT-OF-WAY**

Utility Information: Utility Name: COMCAST COMMUNICATIONS

Address: 121 MARKETRIDGE DR City/State/Zip: RIDGELAND, MS 39517

Contact Person: TANNER ANZ Contact's Phone: 801-989-8726

Project Information: County Road Name: BALEIGH DR

(If located within more than one road right-of-way, use Appendix 1 for additional descriptions)

Beginning Location: 32.517053,-90.061041 Ending Location: 32.517001,-90.060788

Length of Project: 9586' Section: 26 Township: 8N Range: 2E

Description of Work: COMCAST WILL START AT EXISTING POLE THEN RISER DOWN  
AND BORE 9586' PLACING CABLE AND CONDUIT. PLEASE SEE ATTACHMENTS FOR  
EXACT LOCATIONS.

☒ Check Box if Appendix 1 is to be included as a part of this Application

Whereas the above stated Utility makes application to the **Madison County Board of Supervisors** for a Construction Permit. Attached hereto are drawings and plans for the construction of the above facilities located within Madison County owned public rights-of-way. Once stamped by the Madison County Engineering Department, these plans shall not be changed or altered without written approval of the County Engineer, or his representative. A copy of the approved permit and plans shall be on-site at all times during construction.

The Applicant Utility shall comply with all policies, procedures and construction practices as outlined in *A Policy for The Accommodation of Utility Facilities within the Right-of-Way of all Public County Roads* (hereinafter referred to as the "Policy"), as adopted on November 1, 2005, by the **Madison County Board of Supervisors**, and which is hereby made a part of this Application Agreement.

If facilities are to be located within the Rights-of-Way of the County-Federal or State Aid System, Applicant Utility also agrees to comply with applicable provisions of *S.O.P. No. SA II-2-8, Accommodation of Utilities on Rights-of-Way*, issued by the State Aid Engineer and dated July 1, 2005.

The Applicant Utility understands and agrees that, except as herein granted, no right, title, claim, or easement to said road right-of-way is granted by the issuance of this permit. If this Utility is listed in the general provisions of the Policy, it will be adjusted to comply with same without cost to the County, unless the variance from the Policy has been approved by the granting of the Permit pursuant to this Application.

The Applicant Utility further understands that the Utility's engineering, plant, or other personnel will be responsible for the staking and construction supervision of the work set out above and as shown on the attached plans. If work impacts traffic in any way, the appropriate traffic control shall be installed per the *Manual of Uniform Traffic Control Devices*, Latest Edition.

The Applicant Utility understands that the County Engineer, or his representative, may issue a Stop Work Order at any time if it is deemed that site conditions are not suitable for construction or if any of the requirements of this permit are not being met.

Many County Roads have variable Rights-of-Way and/or no Right-of-Way at all and are maintained under a Prescriptive Easement. It is the sole responsibility of the Applicant Utility to verify the existence and limits of public rights-of-way. If none exists, it is the

responsibility of the Applicant Utility to acquire an easement for their Facilities from the applicable property owner(s). Madison County in no way verifies the limits of Right-of-Way as shown on the permit application.

The Applicant Utility shall be responsible for all future maintenance and repair of the facilities installed under this permit. The Applicant Utility shall make future adjustments to, or relocate, the facilities located within road or highway right-of-way when required for road or highway widening or other road or highway construction at no cost to Madison County. The Applicant Utility shall relocate said utilities within sixty (60) days of notification by County by registered mail, return receipt requested, unless otherwise designated by the County Engineer. Further, any maintenance, repair, or construction shall be done in such a manner as to occasion no unreasonable interference with the normal flow and safety to traffic and at the expense of the utility company. When reasonable care has been taken to locate said utility facilities within the right-of-way, the Applicant Utility understands that any damages caused by routine maintenance and construction by County forces shall be borne by the Applicant Utility.

The Applicant Utility further agrees to indemnify and hold Madison County harmless for any and all claims, accidents, damages, liabilities and expenses occasioned wholly, or in part, by any act or omission of applicant, its agents or employees. In case County shall, without fault on its own part, be made a party to any litigation commenced by or against applicant, then applicant shall protect and hold County harmless, and shall pay all costs, expenses and reasonable attorney's fees incurred or paid by County in connection with said litigation.

All underground facilities shall be installed at a depth equal to or greater than 48" below the lowest adjacent grade.

All pipes carrying liquid shall be encased under County maintained roads.

WITNESS the signature of the Applicant this the 8 day of MAY, 2025.

By: Tanner Anz  
(Applicant Signature)

Title: COMCAST COORDINATOR

**Note:** *Applicant must be an employee of the Utility named in this application. The Madison County Board of Supervisors will not recognize a Contractor, Subcontractor, Agent, or Consulting Engineer as the Applicant. Utility Company shall be fully responsible for all work performed under this application.*

I, or my authorized representative, have reviewed this application and determined that the drawing, sketches, and plans submitted by the Applicant meet the requirements of A Policy for The Accommodation of Utility Facilities within the Right-of-Way of all Public County Roads.

**APPROVED**

**By Tim Bryan at 10:36 am, May 15, 2025**

Tim Bryan, P.E.  
County Engineer

AGREED TO AND APPROVED BY:

\_\_\_\_\_  
Madison County Board President

Date: \_\_\_\_\_

ENTERED INTO THE MINUTES OF THE BOARD OF SUPERVISORS OF MADISON COUNTY, MISSISSIPPI ON THIS  
\_\_\_\_ DAY OF \_\_\_\_\_, 20\_\_\_\_.

### Appendix 1

County Road Name: YANDELL RD

Beginning Location: 32.517026,-90.061071 Ending Location: 32.517049,-90.060978

Length of Project: 20' Section: 26 Township: 8N Range: 2E

Description of Work: COMCAST WILL PLACE CABLE AND CONDUIT.

County Road Name: HUNTERS WAY

Beginning Location: \_\_\_\_\_ Ending Location: \_\_\_\_\_

Length of Project: 1824' Section: 26 Township: 8N Range: 2E

Description of Work: COMCAST WILL PLACE CABLE AND CONDUIT.

County Road Name: HUNTERS WAY

Beginning Location: \_\_\_\_\_ Ending Location: \_\_\_\_\_

Length of Project: 1824' Section: 26 Township: 8N Range: 2E

Description of Work: COMCAST WILL PLACE CABLE AND CONDUIT.

County Road Name: BALEIGH WAY

Beginning Location: \_\_\_\_\_ Ending Location: \_\_\_\_\_

Length of Project: 2735' Section: 26 Township: 8N Range: 2E

Description of Work: COMCAST WILL PLACE CABLE AND CONDUIT.

County Road Name: MANDY WAY

Beginning Location: \_\_\_\_\_ Ending Location: \_\_\_\_\_

Length of Project: 898' Section: 26 Township: 8N Range: 2E

Description of Work: COMCAST WILL PLACE CABLE AND CONDUIT.

## Appendix 1

County Road Name: PORTNER WY

Beginning Location: \_\_\_\_\_ Ending Location: \_\_\_\_\_

Length of Project: 1404' Section: 26 Township: 8N Range: 2E

Description of Work: COMCAST WILL PLACE PROPOSED PEDS

\_\_\_\_\_

\_\_\_\_\_

County Road Name: \_\_\_\_\_

Beginning Location: \_\_\_\_\_ Ending Location: \_\_\_\_\_

Length of Project: \_\_\_\_\_ Section: \_\_\_\_\_ Township: \_\_\_\_\_ Range: \_\_\_\_\_

Description of Work: \_\_\_\_\_

\_\_\_\_\_

\_\_\_\_\_

County Road Name: \_\_\_\_\_

Beginning Location: \_\_\_\_\_ Ending Location: \_\_\_\_\_

Length of Project: \_\_\_\_\_ Section: \_\_\_\_\_ Township: \_\_\_\_\_ Range: \_\_\_\_\_

Description of Work: \_\_\_\_\_

\_\_\_\_\_

\_\_\_\_\_

County Road Name: \_\_\_\_\_

Beginning Location: \_\_\_\_\_ Ending Location: \_\_\_\_\_

Length of Project: \_\_\_\_\_ Section: \_\_\_\_\_ Township: \_\_\_\_\_ Range: \_\_\_\_\_

Description of Work: \_\_\_\_\_

\_\_\_\_\_

\_\_\_\_\_

County Road Name: \_\_\_\_\_

Beginning Location: \_\_\_\_\_ Ending Location: \_\_\_\_\_

Length of Project: \_\_\_\_\_ Section: \_\_\_\_\_ Township: \_\_\_\_\_ Range: \_\_\_\_\_

Description of Work: \_\_\_\_\_

\_\_\_\_\_

\_\_\_\_\_



PREPARED BY:  
NWA COMMUNICATIONS  
5553 HWY 145  
SHANNON, MS 38868  
LANE WATTS / 662-687-1044  
lwatts@nwautilities.com  
permits@nwautilities.com

SUBMITTED ON BEHALF OF:  
COMCAST COMMUNICATIONS  
121 MARKETRIDGE DR RIDGELAND, MS 39517  
TANNER ANZ / 801-989-8726  
tanner\_anz@comcast.com

ENGINEERED BY:  
PERMITS@NWAUTILITIES.COM



ENGINEERED FOR:



DISCLAIMER

THESE DRAWINGS AND SPECIFICATIONS  
BEING ISSUED IN STRICT  
CONFIDENCE AND SHALL NOT BE  
REPRODUCED,  
COPIED, OR USED FOR ANY PURPOSE  
WITHOUT SPECIFIC WRITTEN PERMISSION

PROJECT TOTAL FOOTAGES

NEW AERIAL BUILD  
0'  
  
NEW OVERLASH  
0'  
  
NEW BURIED  
9586'



MATERIAL LIST

DESCRIPTION	QUANTITY

PROJECT IDENTIFICATION

JOB #: JB0002159101

PROJECT NAME:

MSMABD230-UG-MADISON COUNTY

ADDRESS, CITY, STATE, ZIP

230 BALEIGH DR CANTON, MS 39046

COUNTY:

MADISON

LEGEND

LINE TYPES

	UG	PROPOSED UNDERGROUND
	A	PROPOSED AERIAL
	EC	EXISTING CONDUIT
	UE	UTILITY EASEMENT
		EDGE OF TRAVEL
		CENTERLINE
		SURVEY CENTERLINE
		RIGHT OF WAY
		DRIVEWAY
	X	FENCE LINE
	PL	PROPERTY LINE
		SIDEWALK
		RAILROAD
	W	WATER
	S	SEWER
	G	GAS
	SD	STORM DRAIN
	T	TELECOMMUNICATIONS
	P	POWER
	UNK	UNKNOWN UTILITY

ABBREVIATIONS

EOP	EDGE OF PAVEMENT
R/W	RIGHT OF WAY
R	RISER
SD	STORM DRAIN
S/W	SIDEWALK
HDPE	HIGH DENSITY POLYETHYLENE
STA.	STATION NUMBER
TELCO	TELECOMMUNICATIONS
HH	HANDHOLE
D/W	DRIVEWAY
CONC.	CONCRETE
F/O	FIBER OPTIC
EC	EXISTING CONDUIT

SYMBOLS

	PROPOSED PEDESTAL WITH SILT FENCE		BRIDGE RAIL
	PROPOSED VAULT WITH SILT FENCE		PROPOSED ANCHOR
	PROPOSED BOREHOLE WITH SILT FENCE		EXISTING ANCHOR
	EXISTING PEDESTAL		STORM DRAIN SYMBOLS
	EXISTING VAULT		STORM DRAIN SYMBOLS
	EXISTING TRANSFORMER		
	EXISTING TELECOMMUNICATIONS		
	EXISTING POWER POLE		
	EXISTING MANHOLE		
	WATER VAULT		
	RISER		
	FIBER STORAGE LOOP		

	ADA RAMP
	NORTH ARROW
	FIRE HYDRANT

ENGINEERED BY:  
PERMITS@NWAUTILITIES.COM



ENGINEERED FOR:



DISCLAIMER

THESE DRAWINGS AND SPECIFICATIONS  
BEING ISSUED IN STRICT  
CONFIDENCE AND SHALL NOT BE  
REPRODUCED,  
COPIED, OR USED FOR ANY PURPOSE  
WITHOUT SPECIFIC WRITTEN PERMISSION

PROJECT TOTAL FOOTAGES

NEW AERIAL BUILD  
0'  
  
NEW OVERLASH  
0'  
  
NEW BURIED  
9586'



MATERIAL LIST

DESCRIPTION	QUANTITY

PROJECT IDENTIFICATION

JOB #: JB0002159101

PROJECT NAME:

MSMABD230-UG-MADISON COUNTY  
ADDRESS, CITY, STATE, ZIP  
230 BALEIGH DR CANTON, MS 39046

COUNTY:

MADISON

SHEET   2   OF   11

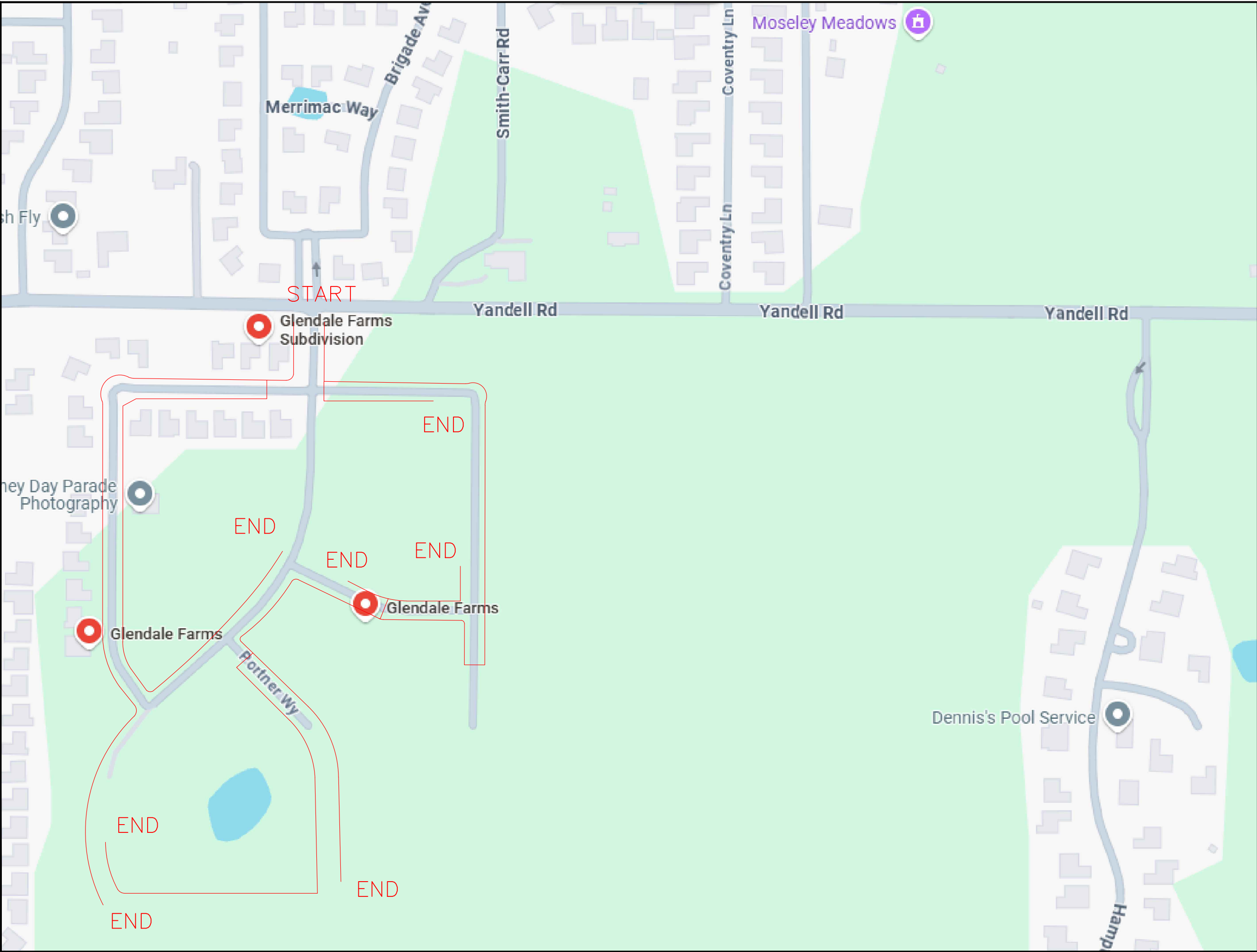

ENGINEERED BY:  
PERMITS@NWAUTILITIES.COM



ENGINEERED FOR:



DISCLAIMER

THESE DRAWINGS AND SPECIFICATIONS  
BEING ISSUED IN STRICT  
CONFIDENCE AND SHALL NOT BE  
REPRODUCED,  
COPIED, OR USED FOR ANY PURPOSE  
WITHOUT SPECIFIC WRITTEN PERMISSION

PROJECT TOTAL FOOTAGES

NEW AERIAL BUILD  
0'  
  
NEW OVERLASH  
0'  
  
NEW BURIED  
9586'



MATERIAL LIST

DESCRIPTION	QUANTITY

PROJECT IDENTIFICATION

JOB #: JB0002159101

PROJECT NAME:  
MSMABD230-UG-MADISON COUNTY  
ADDRESS, CITY, STATE, ZIP  
230 BALEIGH DR CANTON, MS 39046

COUNTY:  
MADISON



ENGINEERED BY:  
PERMITS@NWAUTILITIES.COM



ENGINEERED FOR:



DISCLAIMER

THESE DRAWINGS AND SPECIFICATIONS  
BEING ISSUED IN STRICT  
CONFIDENCE AND SHALL NOT BE  
REPRODUCED,  
COPIED, OR USED FOR ANY PURPOSE  
WITHOUT SPECIFIC WRITTEN PERMISSION

PROJECT TOTAL FOOTAGES

NEW AERIAL BUILD  
0'  
NEW OVERLASH  
0'  
NEW BURIED  
9586'



MATERIAL LIST

DESCRIPTION	QUANTITY

PROJECT IDENTIFICATION

JOB #: JB0002159101

PROJECT NAME:  
MSMABD230-UG-MADISON COUNTY  
ADDRESS, CITY, STATE, ZIP  
230 BAILEIGH DR CANTON, MS 39046

COUNTY:  
MADISON

SHEET 4 OF 11

PROPOSED COMCAST UNDERGROUND  
DIRECTIONAL BORE  
ONE 2" HDPE CONDUIT  
5' MIN DEPTHS ALL POINTS

EXISTING POLE  
NT#16  
RT 27'  
32.517026,-90.061071  
OVERLASH CATV

BORE HOLE  
RT 27'  
3'Wx3'Lx5'D  
32.517053,-90.061041  
BORE HOLE  
RT 27'  
3'Wx3'Lx5'D  
32.517049,-90.060978

BORE HOLE  
LT 27'  
3'Wx3'Lx5'D  
32.517001,-90.060788

SHEET 5



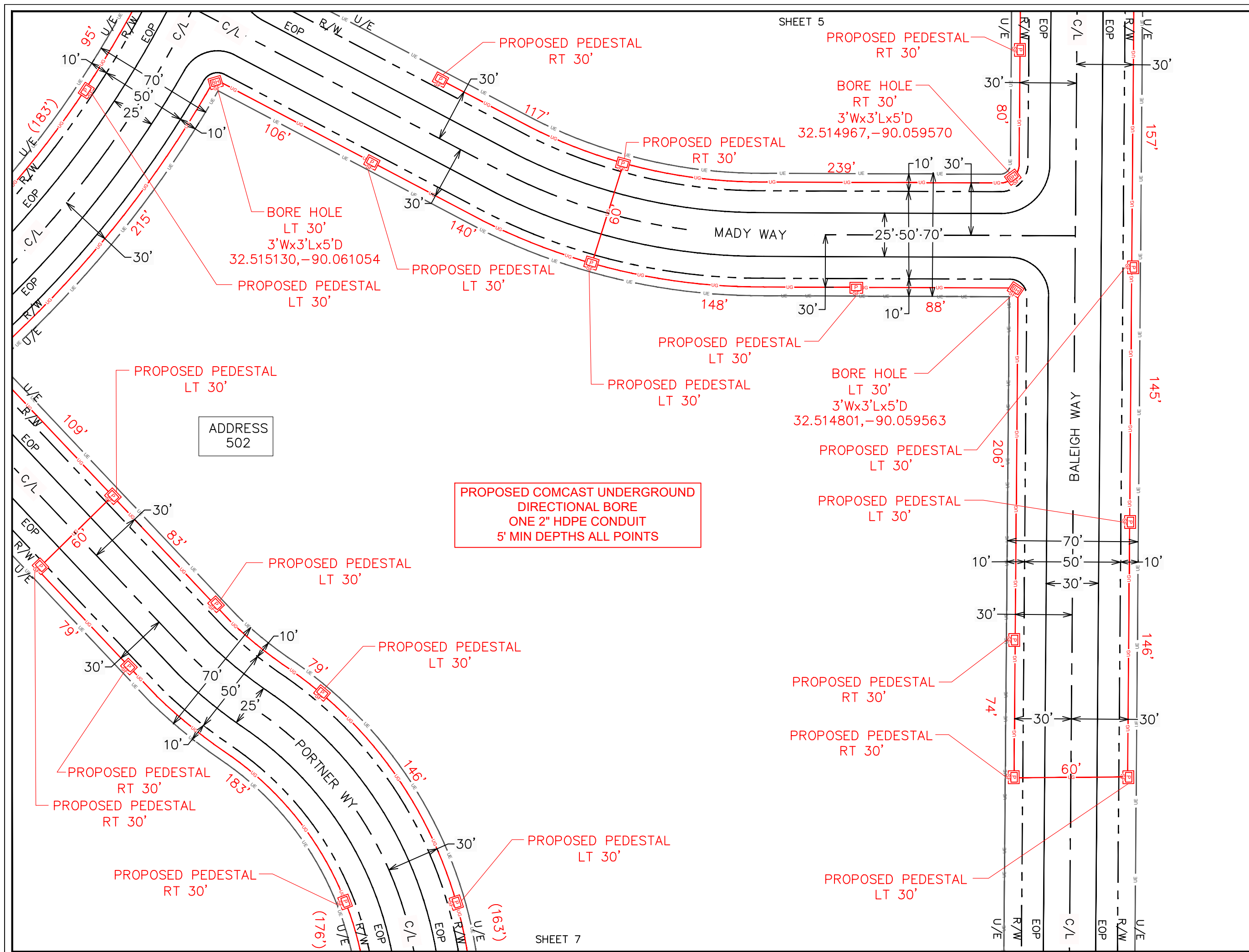

ENGINEERED BY:  
PERMITS@NWAUTILITIES.COM

ENGINEERED FOR:

Know what's below.  
811 before you dig.

DISCLAIMER

THESE DRAWINGS AND SPECIFICATIONS  
BEING ISSUED IN STRICT  
CONFIDENCE AND SHALL NOT BE  
REPRODUCED,  
COPIED, OR USED FOR ANY PURPOSE  
WITHOUT SPECIFIC WRITTEN PERMISSION

PROJECT TOTAL FOOTAGES

NEW AERIAL BUILD  
0'

NEW OVERLASH  
0'

NEW BURIED  
9586'

MATERIAL LIST

DESCRIPTION	QUANTITY

PROJECT IDENTIFICATION

JOB #: JB0002159101

PROJECT NAME:

MSMABD230-UG-MADISON COUNTY

ADDRESS, CITY, STATE, ZIP

230 BAILEIGH DR CANTON, MS 39046

COUNTY:

MADISON

SHEET 6 OF 11

ENGINEERED BY:  
PERMITS@NWAUTILITIES.COM



ENGINEERED FOR:



DISCLAIMER

THESE DRAWINGS AND SPECIFICATIONS  
BEING ISSUED IN STRICT  
CONFIDENCE AND SHALL NOT BE  
REPRODUCED,  
COPIED, OR USED FOR ANY PURPOSE  
WITHOUT SPECIFIC WRITTEN PERMISSION

PROJECT TOTAL FOOTAGES

NEW AERIAL BUILD  
0'  
  
NEW OVERLASH  
0'  
  
NEW BURIED  
9586'



MATERIAL LIST

DESCRIPTION	QUANTITY

PROJECT IDENTIFICATION

JOB #: JB0002159101

PROJECT NAME:  
MSMABD230-UG-MADISON COUNTY  
ADDRESS, CITY, STATE, ZIP  
230 BALEIGH DR CANTON, MS 39046

COUNTY:  
MADISON

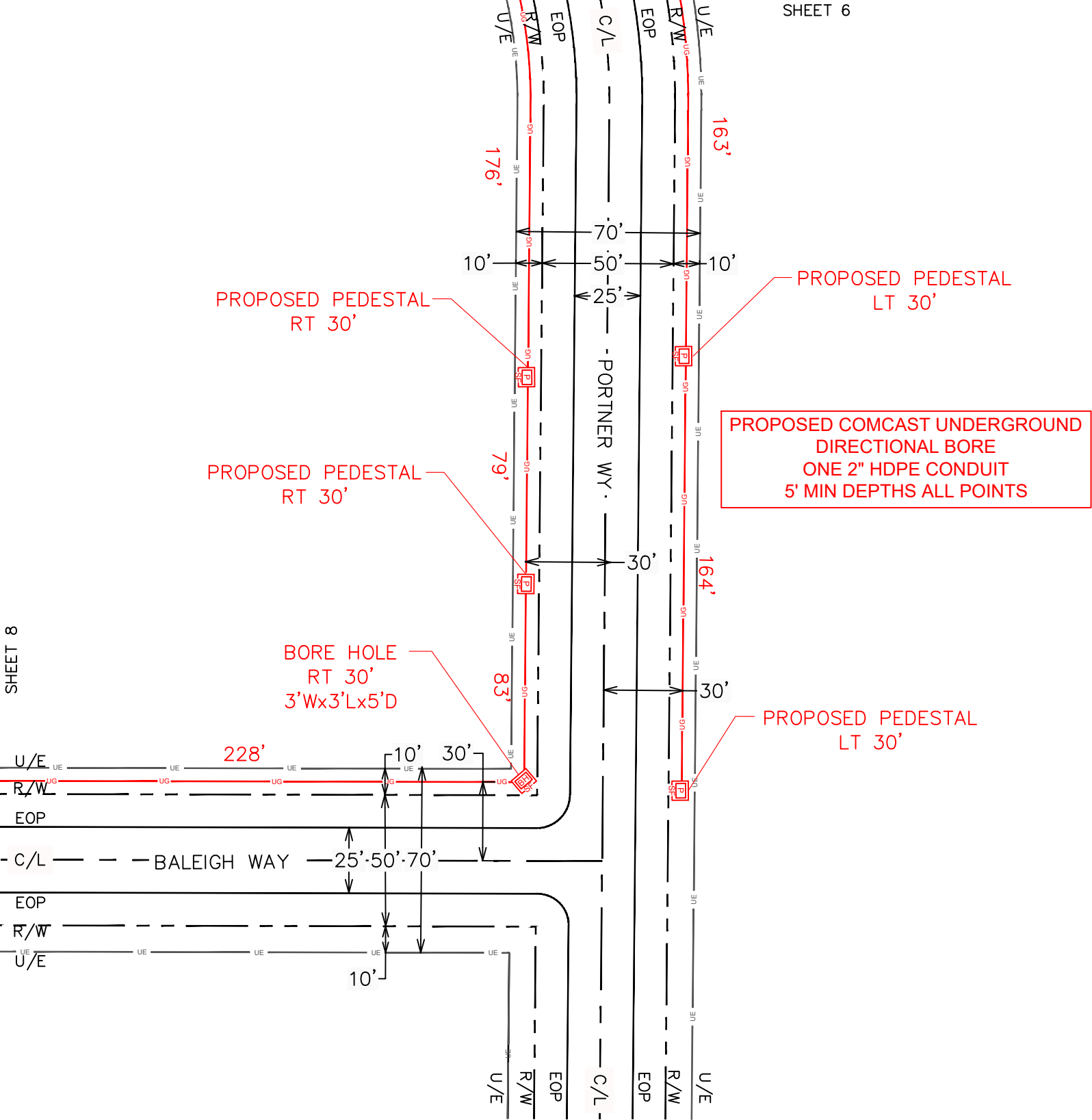
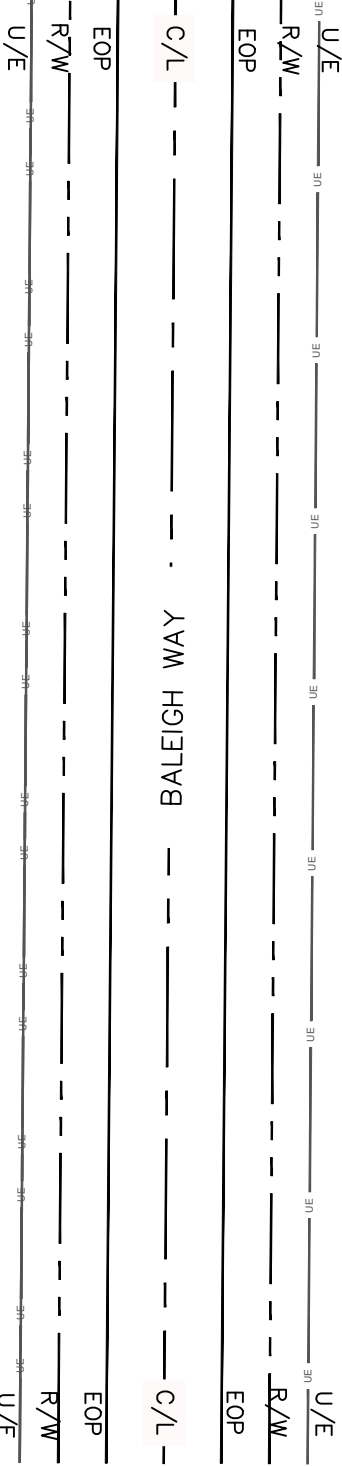





THESE DRAWINGS AND SPECIFICATIONS  
BEING ISSUED IN STRICT  
CONFIDENCE AND SHALL NOT BE  
REPRODUCED,  
COPIED, OR USED FOR ANY PURPOSE  
WITHOUT SPECIFIC WRITTEN PERMISSION

NEW AERIAL BUILD  
0'

NEW OVERLASH  
0'

NEW BURIED  
9586'

[illegible]

SHEET 8 OF 11

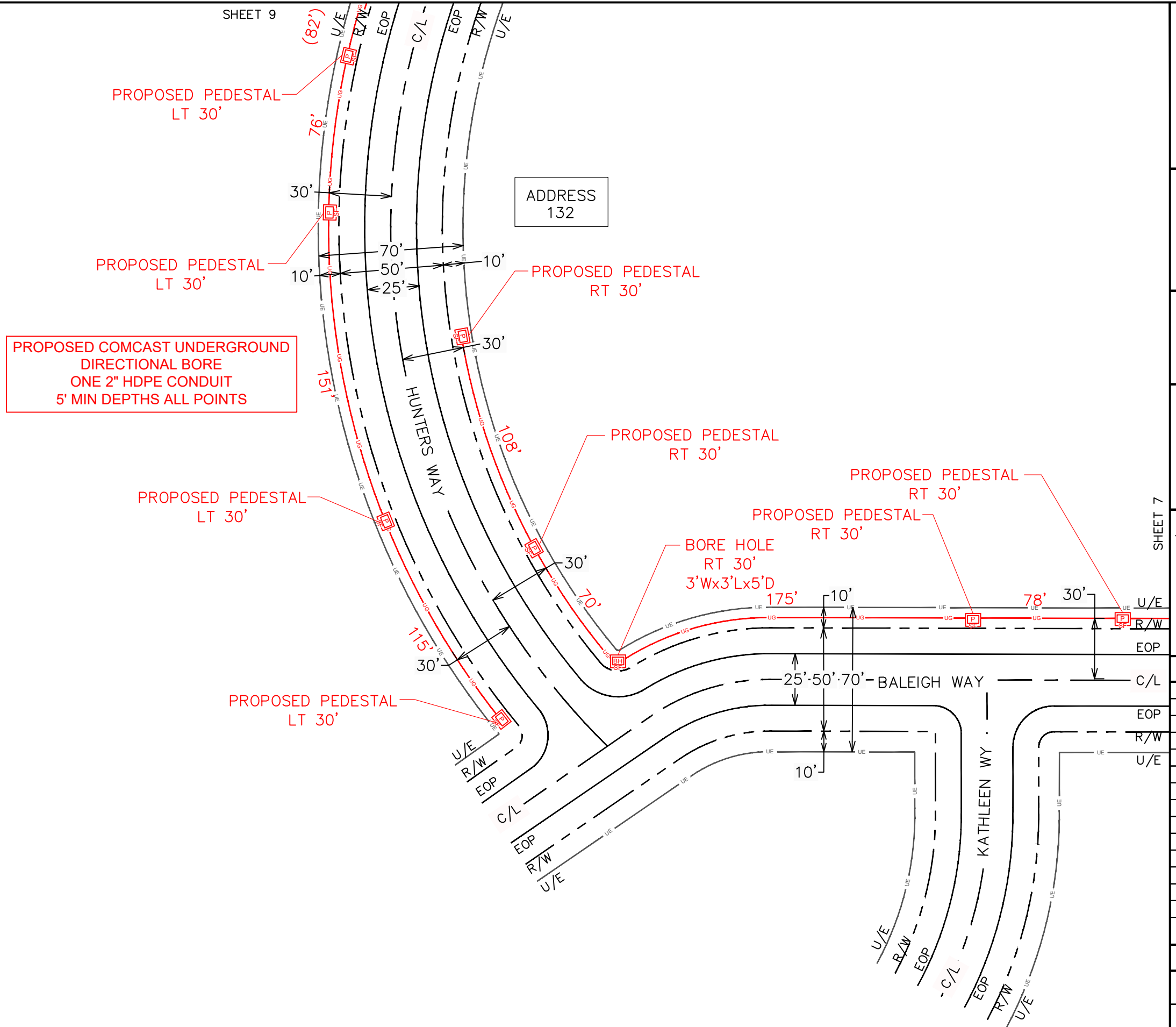



THESE DRAWINGS AND SPECIFICATIONS  
BEING ISSUED IN STRICT  
CONFIDENCE AND SHALL NOT BE  
REPRODUCED,  
COPIED, OR USED FOR ANY PURPOSE  
WITHOUT SPECIFIC WRITTEN PERMISSION

NEW AERIAL BUILD  
0'

NEW OVERLASH  
0'

NEW BURIED  
9586'

[illegible]

JOB #:	JB0002159101
<u>PROJECT NAME:</u>	
MSMABD230-UG-MADISON COUNTY	
<u>ADDRESS, CITY, STATE, ZIP</u>	
230 BALEIGH DR CANTON, MS 39046	
<u>COUNTY:</u>	
MADISON	

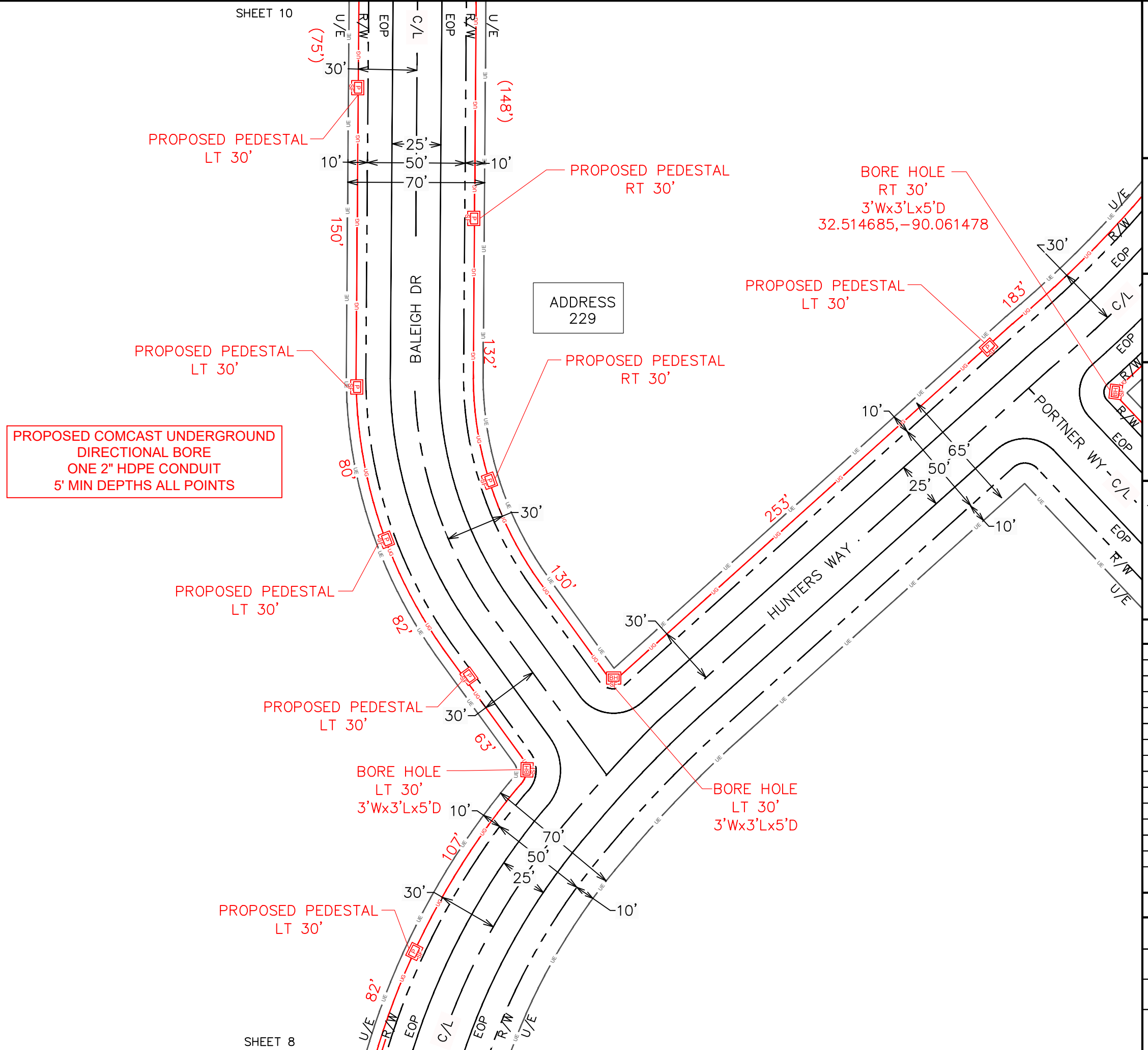



STATE HWY  
TYPICAL AERIAL  
HEIGHT

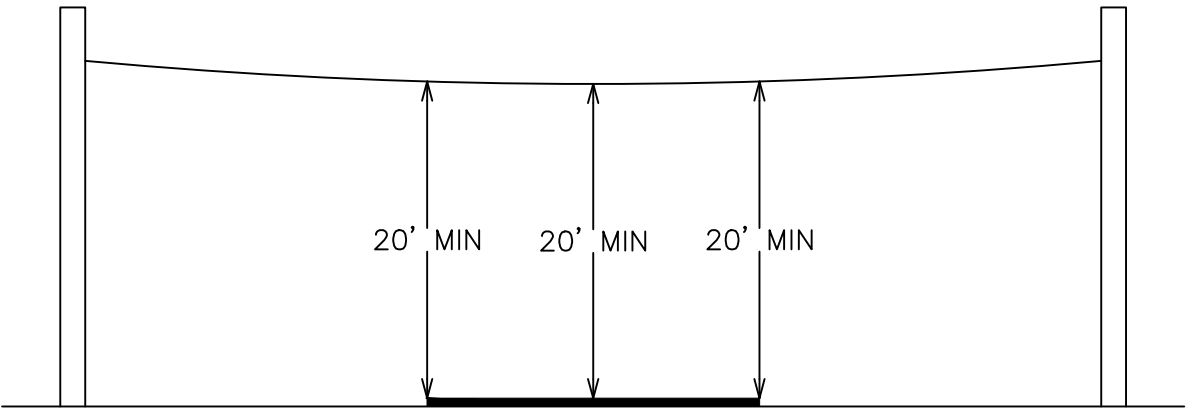

INTERSTATE  
TYPICAL AERIAL  
HEIGHT

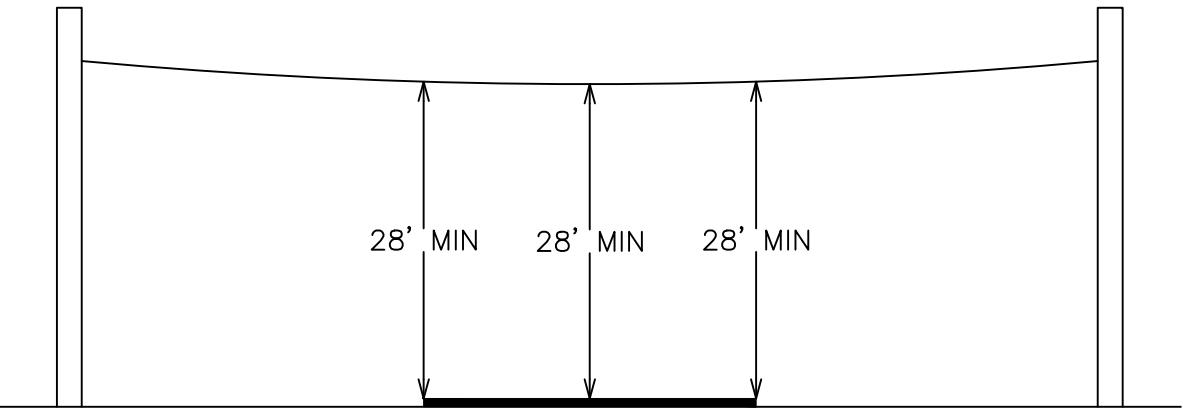

TYPICAL UNDERGROUND  
DEPTH

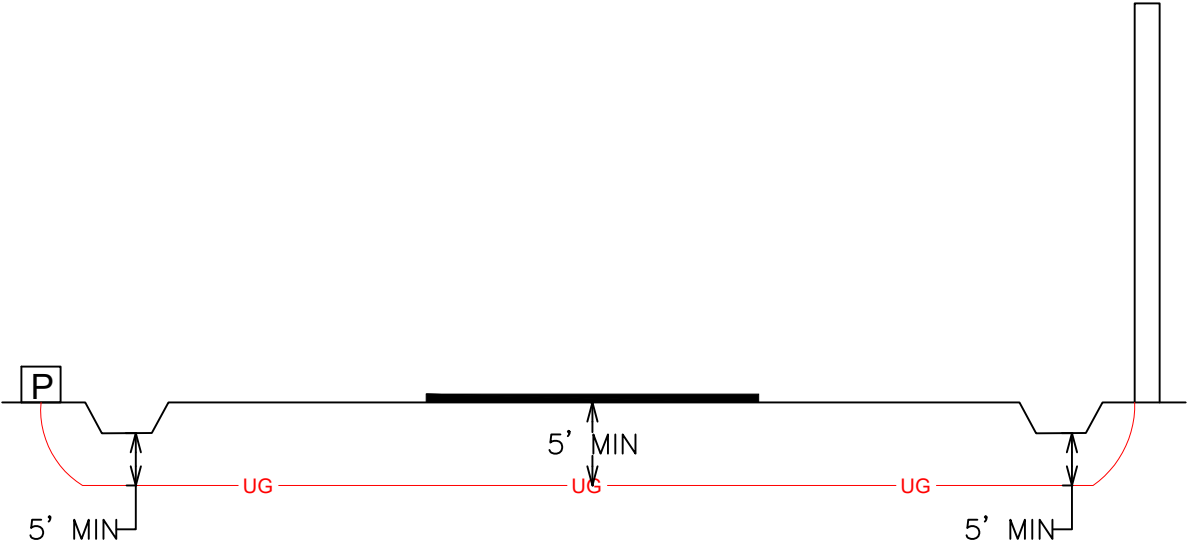

ENGINEERED BY:  
PERMITS@NWAUTILITIES.COM



ENGINEERED FOR:



DISCLAIMER

THESE DRAWINGS AND SPECIFICATIONS  
BEING ISSUED IN STRICT  
CONFIDENCE AND SHALL NOT BE  
REPRODUCED,  
COPIED, OR USED FOR ANY PURPOSE  
WITHOUT SPECIFIC WRITTEN PERMISSION

PROJECT TOTAL FOOTAGES

NEW AERIAL BUILD  
0'  
  
NEW OVERLASH  
0'  
  
NEW BURIED  
9586'



MATERIAL LIST

DESCRIPTION	QUANTITY

PROJECT IDENTIFICATION

JOB #: JB0002159101

PROJECT NAME:

MSMABD230-UG-MADISON COUNTY

ADDRESS, CITY, STATE, ZIP

230 BALEIGH DR CANTON, MS 39046

COUNTY:

MADISON